



# **CABINET HARDWARE SYSTEMS**

**CONCEALED HINGE SYSTEMS**

**#CHS**

# CONCEALED HINGE SYSTEMS

## CONTENTS

- OMNIA L Hinge range .....04
- Easy to install..... 05
- OMNIA L 105° ..... 07
- OMNIA L special application hinges..... 09
- OMNIAL 155° hinges .....11
- OMNIA L for corner cabinet 90° (bifold).....13
- OMNIA L mounting plates for 110° , 45° , 155° blind corner and Bifold hinges.....15
- FGV OneTouch push-to-open device .....16
- FGV Limited Lifetime Warranty ..... 17
- HELIOS 105° HINGE..... 19
- HELIOS 165° CORNER HINGE .....20
- HELIOS MOUNTING PLATES .....21
- HELIOS ASSEMBLY .....22

# CONCEALED HINGE SYSTEMS



FGV - Formenti & Giovenzana is proudly Italian and specialises in functional solutions for cabinets and furniture to meet the needs of customers in Europe and across the globe. With more than 280 million hinges manufactured, FGV is one of the leading hinge manufacturers in the world.

Their goal is to “to ensure that the use of furniture is intuitive, practical and overall pleasant” and with that demonstrate “that good furniture can contribute to improve end consumers’ quality of life”.

The new OMNIA L SlowMotion range is the culmination of FGV’s engineering expertise and does exactly that by improving on many of the perceived shortcomings of hinge systems available today.



# CONCEALED HINGE SYSTEMS

OMNIA L HINGE SYSTEM



## OMNIA L HINGE RANGE

The Omnia L SlowMotion hinge is the new top product of the FGV's offer originates from the research and the experience built up in over 70 years of presence in the field. Equipped with a state-of-the-art Linear SlowMotion Technology, it ensures stable and constant operation in all conditions of use. Produced in Italy it boosts all the best features and performances required by the market of damped systems.



## ALL THE BENEFITS FROM THE LINEAR SLOWMOTION

State-of-the-art Linear SlowMotion Technology, for a perfect damped closure in every condition, based on stable shock absorber at all high and low temperatures, adaptive controlled movement without manual adjustments, 25° of smooth braking to avoid door rebound.

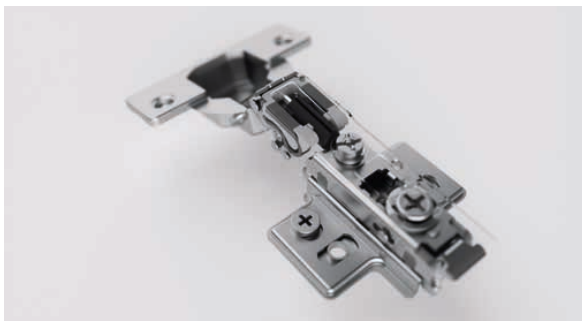

# CONCEALED HINGE SYSTEMS

## OMNIA L HINGE SYSTEM



### NEVER SO EASY TO HANG A DOOR!

No limits to door dimensions and to hinge numbers. AnyClickSystem an intelligent and practical solution to fit the hinges in any position without any stress.

A really fantastic simplification for the wardrobe doors.

#### ► Easy to install

The OMNIA L range is offered as 105° across all major drilling patterns, in the most relevant cranks.

In addition to a screw-fix and the default installation option of a knock-in dowel, select OMNIA L hinges are available with FGV's quarter-turn Velofix dowel that enables locking the hinge into position effortlessly with a simple flick of the wrist.

Mounting plates are exclusively offered as CAM adjustable (screw-fix or with pre-mounted Euro screw) to enable independent 3D alignment. The reversible design of the mounting plate makes installation fast, simple, precise, and intuitive.



# CONCEALED HINGE SYSTEMS

OMNIA L HINGE SYSTEM

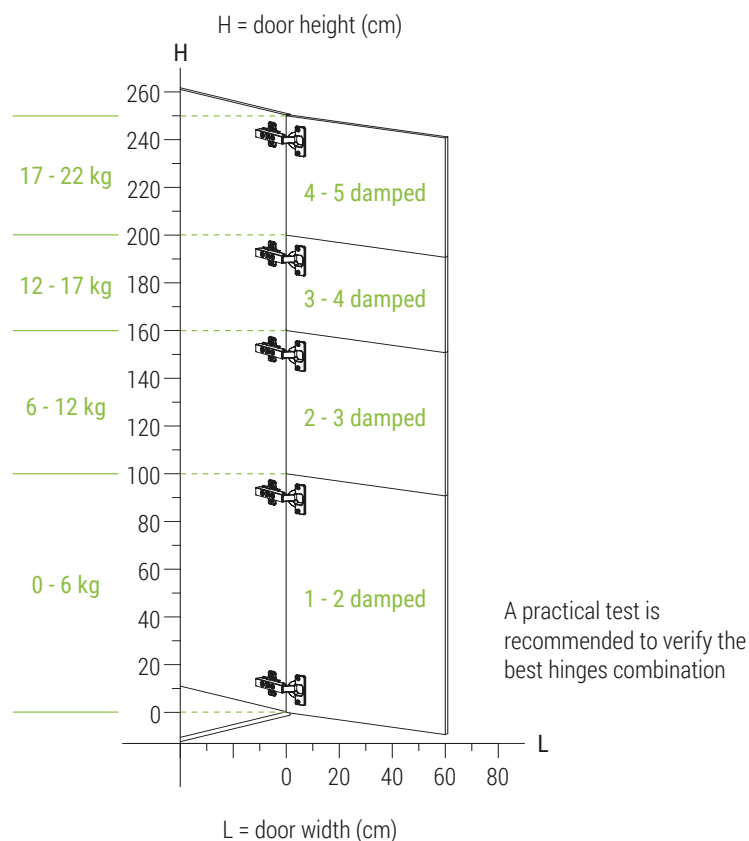

## ANYCLICKSYSTEM

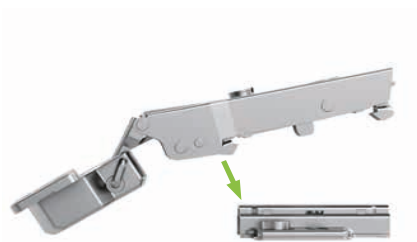

For an easy and quick fitting in any position.

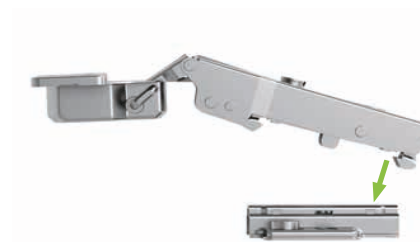
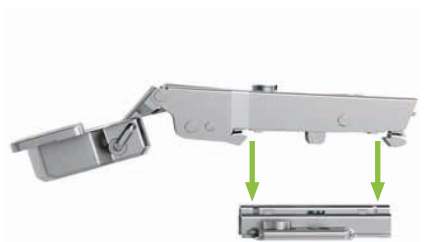

## ADJUSTING SYSTEM



**Depth adjustment**  
Acting on the "A" screw it is possible to adjust the distance between the side of the cabinet and the door.



**Independent side adjustment**  
Acting on the "B" screw it is possible to change the amount of the door covering on the side of the cabinet.



**Vertical adjustment**  
Acting on the "C" screw of the mounting plate it is possible to adjust the door vertically.

# CONCEALED HINGE SYSTEMS

## OMNIA L HINGE SYSTEM



### ► OMNIA L 105°

- Depth of the metal cup 11.4 mm
- Cup diameter 35 mm
- Opening 105°
- Possibility of door drilling (K) from 3 to 7 mm
- Thickness of the door (T) from 14 to 26 mm Available with cup hole distance I.48, A.45, D.52 C.
- Available fixing systems with; screw-fix, knock-in dowel and velofix



LINEAR  
DAMPER

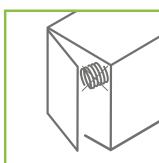





NO REBOUND

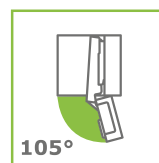

ANYCLICK  
SYSTEM



OPENING

			CLOSING TYPE	FIXING TYPE		
				SCREW-FIX	KNOCK-IN	VELO-FIX
I-PATTERN 48/6MM	Crank 0 Full overlay		STANDARD	OMNL.48.105.STD.0.SF	OMNL.48.105.STD.0.KI	OMNL.48.105.STD.0.VF
			SOFT-CLOSE	OMNL.48.105.SCL.0.SF	OMNL.48.105.SCL.0.KI	OMNL.48.105.SCL.0.VF
	Crank 8 Half overlay		STANDARD		OMNL.48.105.STD.8.KI	
			SOFT-CLOSE	OMNL.48.105.SCL.8.SF	OMNL.48.105.SCL.8.KI	
Crank 15 Inset		STANDARD		OMNL.48.105.STD.15.KI		
		SOFT-CLOSE	OMNL.48.105.SCL.15.SF		OMNL.48.105.SCL.15.VF	
B-PATTERN 45/9.5MM	Crank 0 Full overlay		STANDARD		OMNL.45.105.STD.0.KI	OMNL.45.105.STD.0.VF
			SOFT-CLOSE		OMNL.45.105.SCL.0.KI	OMNL.45.105.SCL.0.VF
H-PATTERN 52/5.5MM	Crank 0 Full overlay		STANDARD			OMNL.52.105.STD.0.VF
			SOFT-CLOSE			OMNL.52.105.SCL.0.VF

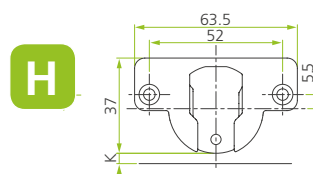
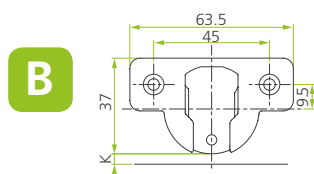
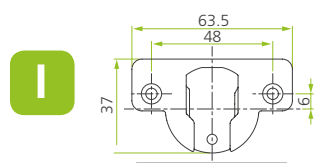

STD = STANDARD  
SCL = SOFT CLOSE

SF = SCREW-FIX  
KI = KNOCK-IN  
VF = VELO-FIX

I, H = DOWELS 10MM  
B = DOWELS 8MM

# CONCEALED HINGE SYSTEMS

## OMNIA L HINGE SYSTEM

### CRANK 0 Full overlay doors

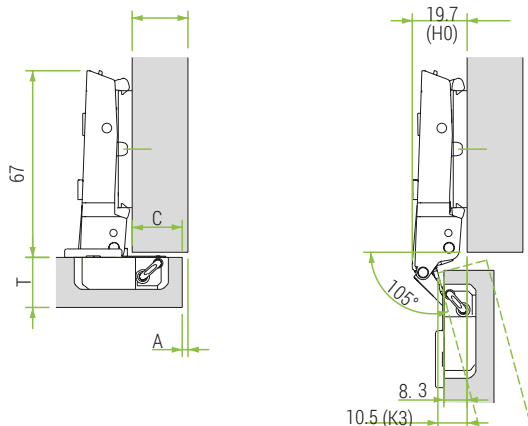

#### Omnia L 105°

H*	Drilling distance (k)				
	3	4	5	6	7
Overlay (C) Crank 0	19			0	
	18		0		2
	17		0	2	
	16	0		2	4
	15		2		4
	14	2		4	6
	13		4		6
	12	4		6	
	11		6		
	10	6			

\* = with H between two values get the lower one

### CRANK 8 Half overlay doors

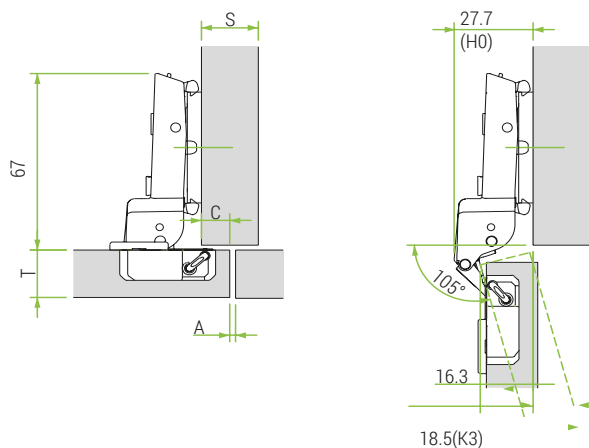

H*	Drilling distance (k)				
	3	4	5	6	7
Overlay (C) Crank 8	11			0	
	10		0		2
	9		0	2	
	8	0		2	4
	7		2		4
	6	2		4	6
	5		4		6
	4	4		6	
	3		6		
	2	6			

\* = with H between two values get the lower one

### CRANK 15 For inset doors

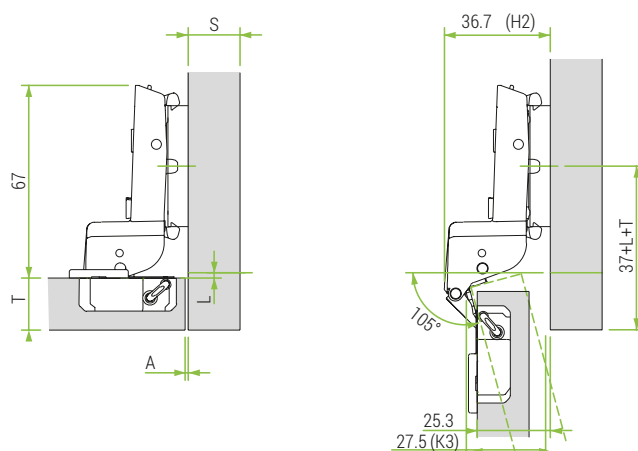

H*	Drilling distance (k)				
	3	4	5	6	7
Overlay (C) Crank 15	1	0		2	4
	0		2		4
	-1	2		4	6
	-2		4		6
	-3	4		6	
	-4		6		
	-5				
	-6				
	-7				
	-8				

\* = with H between two values get the lower one

Table to determinate the minimum distance A so that a door with T thickness can open without protrusion from the cabinet and without interfering with adjacent doors.

T=	14	15	16	17	18	19	20	21	22	23	24	25	26
K=3 A=	0.1	0.2	0.3	0.4	0.5	0.7	0.8	1	1.2	2	3.2	4.5	5.8
K=4 A=	0.1	0.2	0.3	0.4	0.5	0.6	0.8	1	1.2	1.4	2.2	3.5	4.9
K=5 A=	0.1	0.2	0.3	0.3	0.5	0.6	0.8	1	1.2	1.4	1.6	2.5	3.8
K=6 A=	0.1	0.2	0.3	0.3	0.5	0.6	0.8	1	1.2	1.4	1.6	1.9	2.8
K=7 A=	0.1	0.2	0.3	0.3	0.5	0.6	0.8	1	1.2	1.4	1.6	1.9	2.8

# CONCEALED HINGE SYSTEMS

## OMNIA L HINGE SYSTEM



### ► OMNIA L special application hinges

Solutions for 90° blind corners or 45° corners.

- Depth of the metal cup 11.4mm
- Cup diameter 35mm
- Opening 105°
- Possibility of door drilling (K) from 3 to 7mm
- Thickness of the door (T) from 14 to 26mm
- Require OMNIA L mounting plates with ANYCLICK SYSTEM



LINEAR  
DAMPER

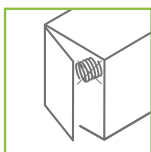

NO REBOUND



ANYCLICK  
SYSTEM

			CLOSING TYPE	FIXING TYPE		
				SCREW-FIX	KNOCK-IN	VELO-FIX
<b>I-PATTERN</b> 48/6MM	<b>105° / 90° Blind Corner</b>		STANDARD	<b>OMNL.48.BC.STD.SF</b>		<b>OMNL.48.BC.STD.VF</b>
			SOFT-CLOSE	<b>OMNL.48.BC.SCL.SF</b>		<b>OMNL.48.BC.SCL.VF</b>
	<b>45° Angled Corner</b>		STANDARD			
			SOFT-CLOSE	<b>OMNL.48.45.SCL.0.SF</b>		
<b>B-PATTERN</b> 45/9.5MM	<b>105° / 90° Blind Corner</b>		STANDARD			<b>OMNL.45.BC.STD.VF</b>
			SOFT-CLOSE			<b>OMNL.45.BC.SCL.VF</b>

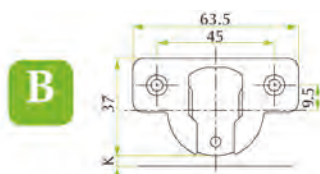
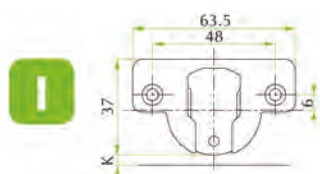

STD = STANDARD  
SCL = SOFT CLOSE  
SF = SCREW-FIX  
KL = KNOCK-IN  
VF = VELO-FIX  
I = DOWELS 10MM B  
= DOWELS 8MM

# CONCEALED HINGE SYSTEMS

OMNIA L HINGE SYSTEM



LINEAR  
DAMPER

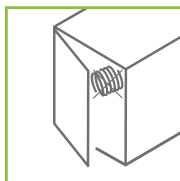

NO REBOUND



ANYCLICK  
SYSTEM

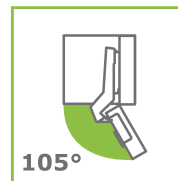

OPENING

ANGLE 45°

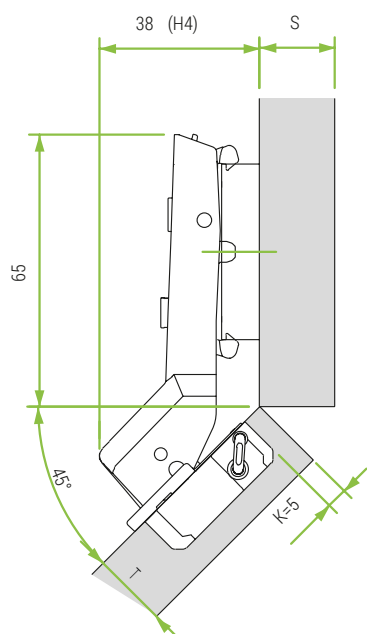

ANGLE 90°

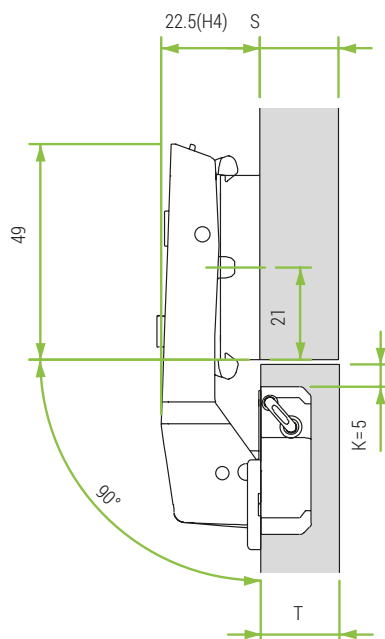
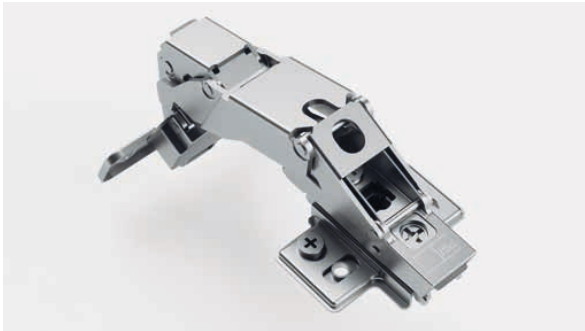

Table to determinate the minimum distance A so that a door with T thickness can open without protrusion from the cabinet and without interfering with adjacent doors.

	T=	14	15	16	17	18	19	20	21	22	23	24	25	26
K=3	A=	0.1	0.2	0.3	0.4	0.5	0.7	0.8	1	1.2	2	3.2	4.5	5.8
K=4	A=	0.1	0.2	0.3	0.4	0.5	0.6	0.8	1	1.2	1.4	2.2	3.5	4.9
K=5	A=	0.1	0.2	0.3	0.3	0.5	0.6	0.8	1	1.2	1.4	1.6	2.5	3.8
K=6	A=	0.1	0.2	0.3	0.3	0.5	0.6	0.8	1	1.2	1.4	1.6	1.9	2.8
K=7	A=	0.1	0.2	0.3	0.3	0.5	0.6	0.8	1	1.2	1.4	1.6	1.9	2.8

# CONCEALED HINGE SYSTEMS

## OMNIA L HINGE SYSTEM



### ► OMNIA L 155°

#### Technical Specifications:

- Depth of the metal cup 11.3 mm
- Cup diameter 35 mm
- Opening 155\*
- Possibility of door drilling (K) from 3 to 7mm
- Thickness of the door (T) from 14 to 26 mm
- Available with cup hole distance I.48
- Available fixing systems with; screw-fix, knock-in dowel



LINEAR  
DAMPER



NO REBOUND



ANYCLICK  
SYSTEM



155°  
OPENING

			CLOSING TYPE	FIXING TYPE	
				SCREW-FIX	KNOCK-IN
I-PATTERN 48/6MM	155° Corner Hinge		STANDARD	OMNL.48.155.STD.0.SF	OMNL.48.155.STD.0.KI
			SOFT-CLOSE	OMNL.48.155.SCL.0.SF	OMNL.48.155.SCL.0.KI

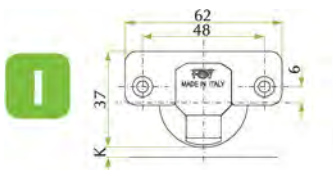

STD = STANDARD  
SCL = SOFT CLOSE  
SF = SCREW-FIX  
KL = KNOCK-IN  
I, H = DOWELS 10MM

# CONCEALED HINGE SYSTEMS

## OMNIA L HINGE SYSTEM

### Omnia L 155°

**CRANK 0** For full overlay doors

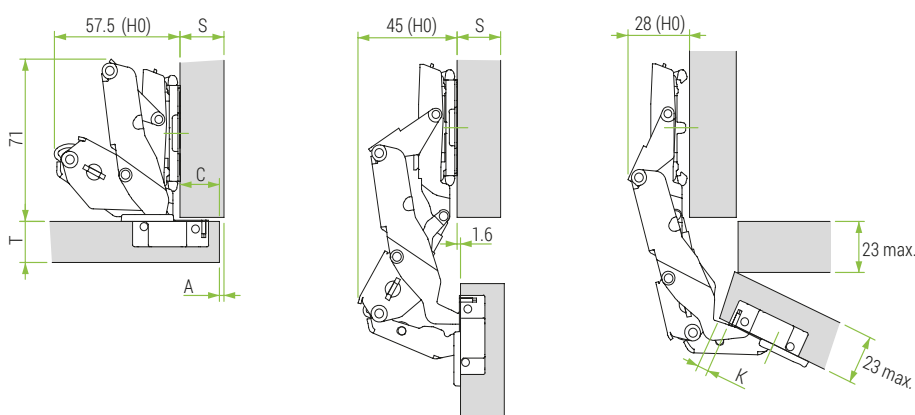

H*	Drilling distance (k)				
	3	4	5	6	7
Overlay (C) Crank 0	19			0	
	18		0	2	
	17	0		2	
	16	0	2		4
	15	2		4	
	14	2	4		6
	13	4		6	
	12	4	6		
	11	6			
	10	6			

\* = with H between two values get the lower one

Table to determinate the minimum distance A so that a door with T thickness can open without protrusion from the cabinet and without interfering with adjacent doors.

T=	14	15	16	17	18	19	20	21	22	23	24	25	26
K=3 A=	0	0	0	0	0	0	0	0	0	0	0	13.7	18
K=4 A=	0	0	0	0	0	0	0	0	0	0	0	12.7	17
K=5 A=	0	0	0	0	0	0	0	0	0	0	7.4	11.7	16
K=6 A=	0	0	0	0	0	0	0	0	0	0	6.4	10.7	15
K=7 A=	0	0	0	0	0	0	0	0	0	0	5.4	9.7	14

# CONCEALED HINGE SYSTEMS

## OMNIA L HINGE SYSTEM

### Omnia L for corner cabinet 90° (Bifold)



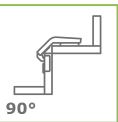

#### Technical Specifications:

- Depth of the metal cup 11.4 mm
- Cup diameter 35 mm
- Opening 50°
- Possibility of door drilling (K) from 3 to 7 mm
- Thickness of the door (T) from 14 to 26 mm
- Available with cup hole distance I.48, A.45
- Available fixing systems with; screw-fix, knock-in dowel



OPENING

			CLOSING TYPE	FIXING TYPE	
				SCREW-FIX	KNOCK-IN
I-PATTERN 48/6MM	Pie-cut corner (PCC) / bifold		STANDARD	OMNL.48.BIF.PCC.SF	OMNL.48.BIF.PCC.KI
B-PATTERN 45/9.5MM	Pie-cut corner (PCC) / bifold		STANDARD		OMNL.45.BIF.PCC.KI

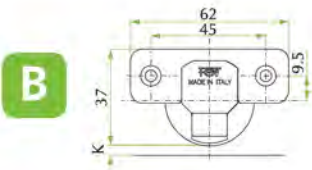
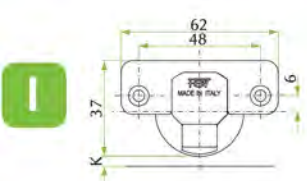

STD = STANDARD  
SCL = SOFT CLOSE  
SF = SCREW-FIX  
KL = KNOCK-IN  
I, H = DOWELS 10MM  
B = DOWELS 8MM

# CONCEALED HINGE SYSTEMS

OMNIA L HINGE SYSTEM

## Omnia L for corner cabinet 90° (Bifold)

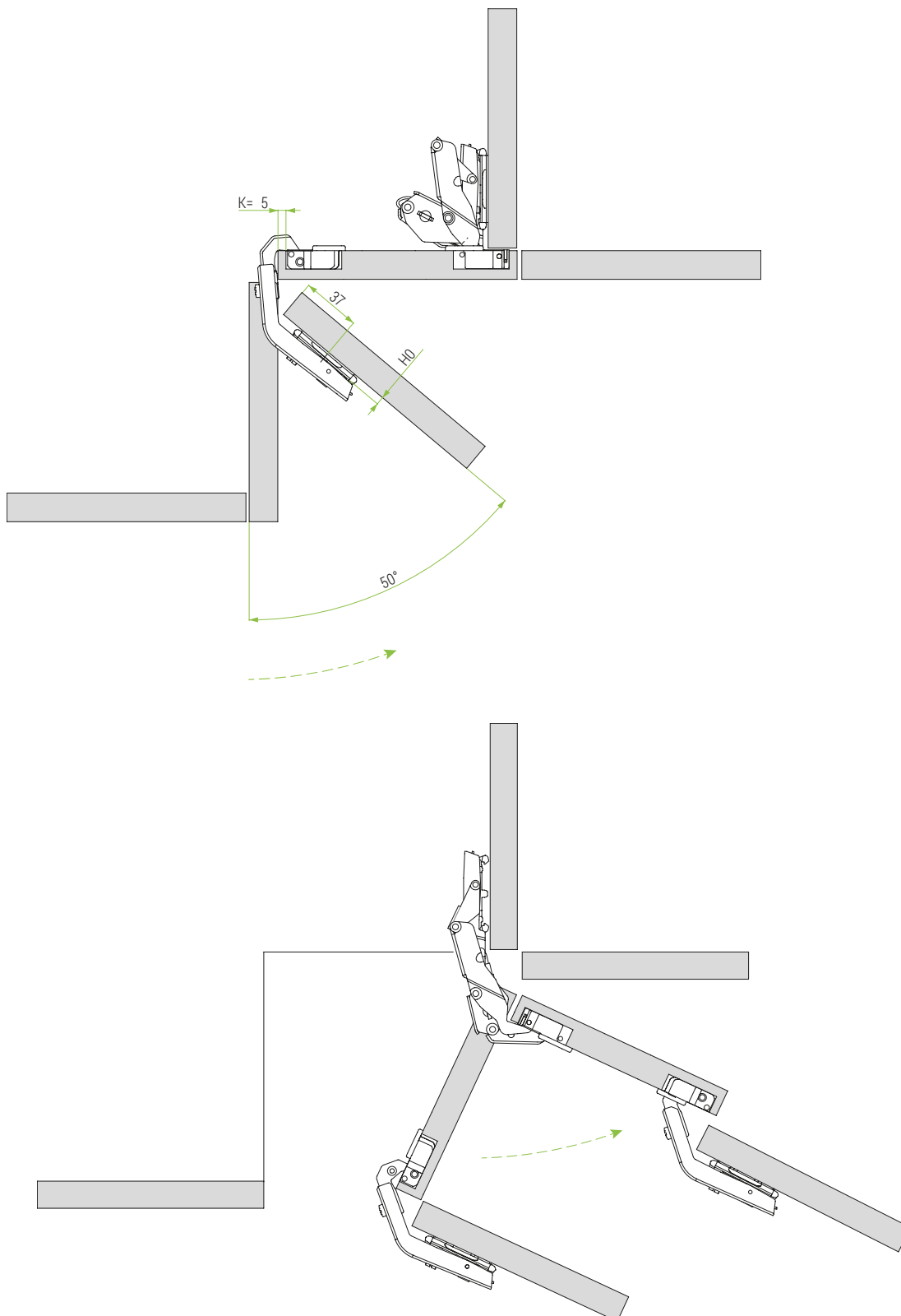

# CONCEALED HINGE SYSTEMS

## OMNIA L HINGE SYSTEM

### ► OMNIA L mounting plates for 105°, 45°, 155°, 90° blind corner and Bifold Hinges

Metal cruciform mounting plate for screw fixing. Independent vertical adjustment with Cam.



SCREW-FIX

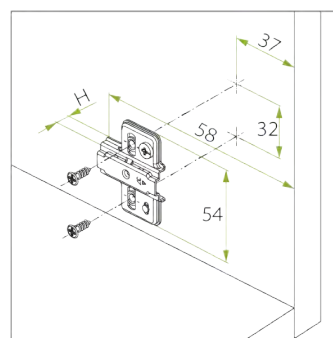

Height	Code
H=0	OMNL.PLT.SCW.CAM.H0
H=2	OMNL.PLT.SCW.CAM.H2
H=4	OMNL.PLT.SCW.CAM.H4

Metal cruciform mounting plate. Euro screws premounted. Independent vertical adjustment with Cam.



PRE-MOUNTED EURO SCREWS

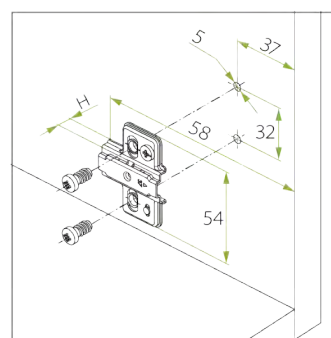

Height	Code
H=0	OMNL.PLT.PME.CAM.H0
H=2	OMNL.PLT.PME.CAM.H2
H=4	OMNL.PLT.PME.CAM.H4

### ► OMNIA L hinge cup cover cap

Cover cap for OMNIA L hinges (any drilling pattern or fixing type)



Code	Description
OMN.HGE.CCC	Omnia hinge cup cover cap, each

# CONCEALED HINGE SYSTEMS

PUSH-TO-OPEN



## ► FGV OneTouch push-to-open device

- A touch of elegance for handleless doors
- Long version for application with standard hinges
- Linear mounting plate
- Activation push of 40mm
- +4mm adjustment
- Without magnet, plate not required



Code	Description
<b>FGV.PTO.40.LMP</b>	Set of OneTouch device 40mm, linear mounting plate included

## Installation Dimensions

## Adjustment

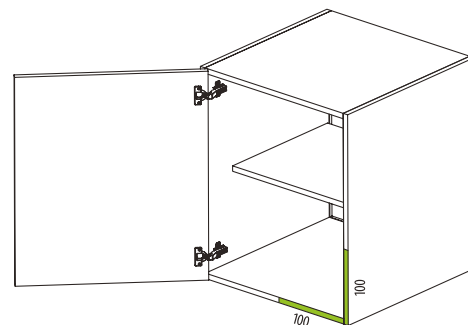
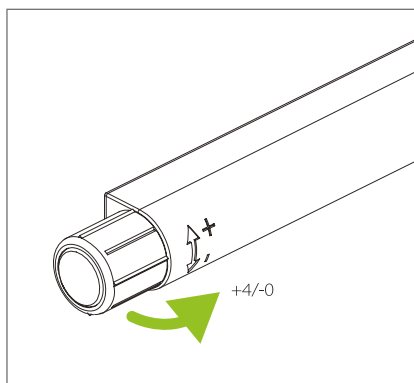
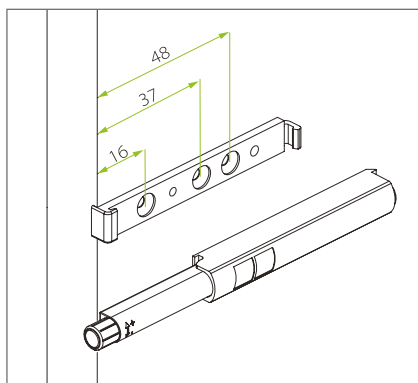

## Installation instructions:

The OneTouch device for handleless doors is best mounted in the corresponding area of the handle i.e. inside 100mm of the bottom corner opposite of the hinges.

# CONCEALED HINGE SYSTEMS

FGV HINGE SYSTEMS



---

## ► FGV Limited Lifetime Warranty

All FGV products are engineered and produced in compliance with ISO 9001 and ISO 14001 principles. To grant a steady quality level, and a proper furniture functioning throughout its lifetime, up to 15 years, FGV products are tested in their internal Quality Department and submitted for further testing to external independent international testing organizations.

FGV will replace any defective product in case the original purchaser is in possession of the furniture, the product has been properly installed according to the manufacturer's specifications, used only in domestic circumstances, under normal working conditions and without any modification. FGV will replace any defective product with an identical one or reasonably equivalent. The free of charge replacement will be carried out against the presentation of a brief product failure report, the defective product itself, and a copy of the proof of purchase, within 30 days of the product failure occurring.

To the fullest extent permitted by law, all other claims are excluded, including shipping expenses, labour costs related to the removal of the defective product, installation of the replacement and any other additional charge. All services are provided without acknowledgment of any legal responsibility, they are subject to changes without prior notice, and subjected to the standard terms of supply.

# CONCEALED HINGE SYSTEMS

## HELIOS HINGE SYSTEM



**FUNCTIONAL**  
**RELIABLE**  
**NO WORRIES**

**HELIOS Hinge System** is designed to cover the everyday requirements of cabinet makers and furniture manufacturers.

The comprehensive hinge system offers smooth movement, even under load. With a clip-on design, it is easy to install and meets all the requirements for standard applications.

Backed by 80,000 life cycle and 48 hour salt spray tests, you can rest assured that attractive pricing doesn't come at the expense of quality and performance.

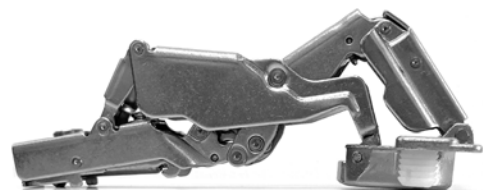

# CONCEALED HINGE SYSTEMS

## HELIOS HINGE SYSTEM

### ► HELIOS 105° HINGE



- Concealed hinge for clip-on installation
- Available as standard close or integrated soft-close
- Opening angle 105°
- For door thickness 15-22mm
- Cup diameter 35mm
- Cup depth 11.5mm
- Right & left adjustment +2.5mm/-2.5mm
- Depth adjustment via cam +3mm/-1mm
- Height adjustment via adjustable plate +2.0mm/-2.0mm

CRANK 0 / FULL OVERLAY	STANDARD CLOSE / SPRUNG		
	48MM / I - PATTERN	45MM / B - PATTERN	52MM / H - PATTERN
<b>SCREW-FIX</b>	HHS.48.105.STD.0.SF		
<b>M10 KNOCK-IN</b>	HHS.48.105.STD.0.KI		HHS.52.105.STD.0.KI
<b>M8 KNOCK-IN</b>		HHS.45.105.STD.0.KI	

CRANK 0 / FULL OVERLAY	SOFT - CLOSE		
	48MM / I - PATTERN	45MM / B - PATTERN	52MM / H - PATTERN
<b>SCREW-FIX</b>	HHS.48.105.SCL.0.SF		
<b>M10 KNOCK-IN</b>	HHS.48.105.SCL.0.KI		HHS.52.105.SCL.0.KI
<b>M8 KNOCK-IN</b>		HHS.45.105.SCL.0.KI	

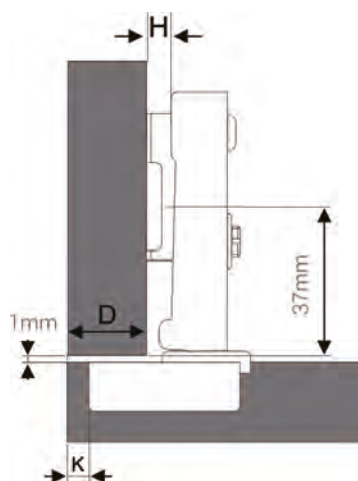

D   K	CUP DISTANCE				
	3	4	5	6	7
21.0					0
20.0				0	
19.0			0		2
18.0		0		2	
17.0	0		2		
16.0		2			
15.0	2				

Mounting plate height

# CONCEALED HINGE SYSTEMS

## HELIOS HINGE SYSTEM

### ► HELIOS 165° CORNER HINGE

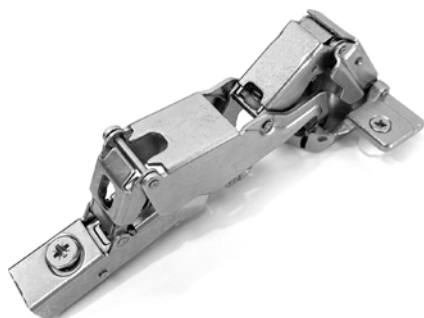

- Concealed corner or pantry door hinge for clip-on installation
- Available as standard close or integrated soft-close
- Opening angle 165°
- For door thickness 14-26mm
- Cup diameter 35mm
- Cup depth 11.5mm
- Right & left adjustment +2.5mm/-2.5mm
- Depth adjustment via cam +3mm/-1mm
- Height adjustment via adjustable plate +2.0mm/-2.0mm

CRANK 0 / FULL OVERLAY	STANDARD CLOSE / SPRUNG		
	48MM / I - PATTERN	45MM / B- PATTERN	52MM / H - PATTERN
M10 KNOCK-IN	HHS.48.165.STD.0.KI		

CRANK 0 / FULL OVERLAY	SOFT - CLOSE		
	48MM / I - PATTERN	45MM / B- PATTERN	52MM / H - PATTERN
M10 KNOCK-IN	HHS.48.165.SCL.0.KI		

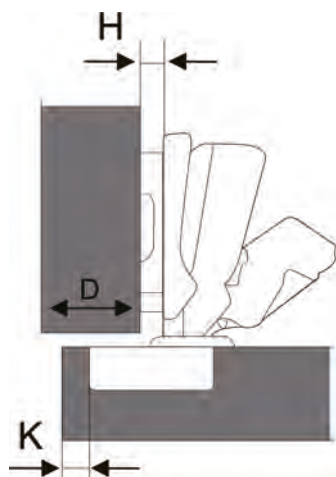

D   K	CUP DISTANCE				
	3	4	5	6	7
21.0					0
20.0				0	
19.0			0		2
18.0		0		2	
17.0	0		2		
16.0		2			
15.0	2				

Door overlay

Mounting plate height

# CONCEALED HINGE SYSTEMS

## HELIOS HINGE SYSTEM

### ► HELIOS MOUNTING PLATES

#### FIXED PLATE



PLATE	HEIGHT	
	H = 0	H = 2
<b>SCREW-FIX</b>	HHS.PLT.SCW.FX.H0	HHS.PLT.SCW.FX.H2
<b>PME / PREMOUNTED EURO SCREW</b>	HHS.PLT.PME.FX.H0	HHS.PLT.PME.FX.H2

#### CAM ADJUSTABLE PLATE

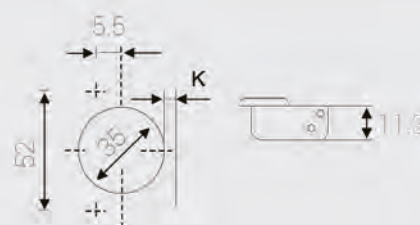
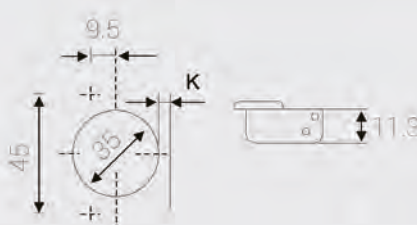
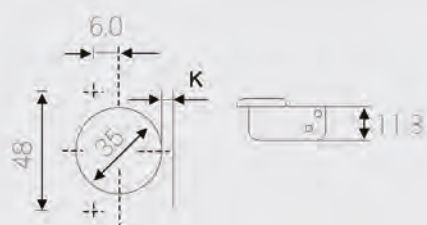

PLATE	HEIGHT	
	H = 0	H = 2
<b>SCREW-FIX</b>	HHS.PLT.SCW.CAM.H0	HHS.PLT.SCW.CAM.H2
<b>PME / PREMOUNTED EURO SCREW</b>	HHS.PLT.PME.CAM.H0	HHS.PLT.PME.CAM.H2

#### 48mm / I-pattern

#### 45mm / B-pattern

#### 52mm / H-pattern



# CONCEALED HINGE SYSTEMS

## HELIOS HINGE SYSTEM

### ► HELIOS ASSEMBLY

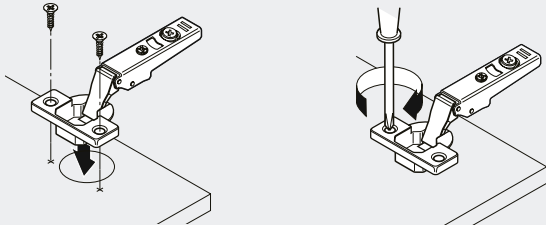
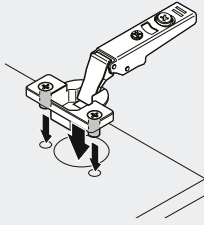
SCREW-FIX HINGE	KNOCK-IN HINGE
	

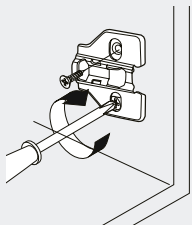
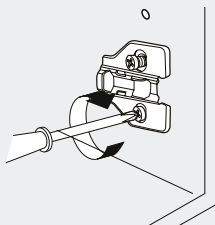
SCREW-FIX PLATE	PME (PRE-MOUNTED EURO SCREW) PLATE
 <p>Use chipboard screw to fix the base</p>	

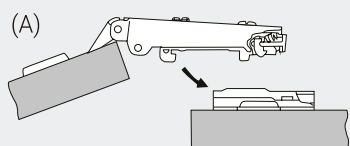
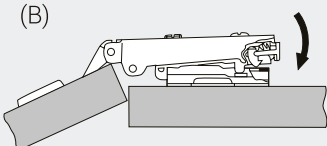
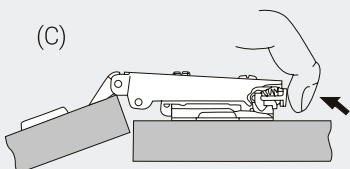
CLIP-ON MOUNTING & RELEASE		
 <p>(A)</p>	 <p>(B)</p>	 <p>(C)</p>

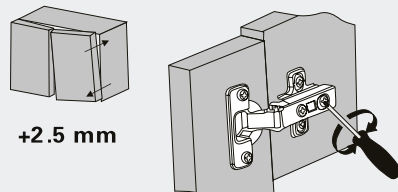
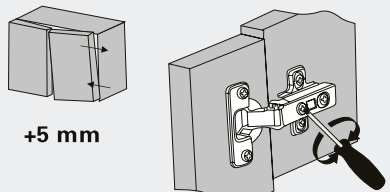
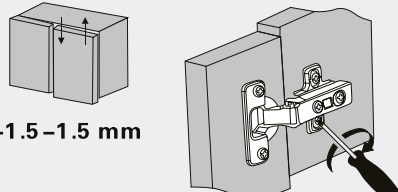
DEPTH ADJUSTMENT	HORIZONTAL / R & L ADJUSTMENT	VERTICAL / UP & DOWN ADJUSTMENT
 <p>+2.5 mm</p>	 <p>+5 mm</p>	 <p>+1.5 -1.5 mm</p>

WITH CAM ADJUSTABLE PLATE ONLY